

SPEED BOX

by HanleyLED

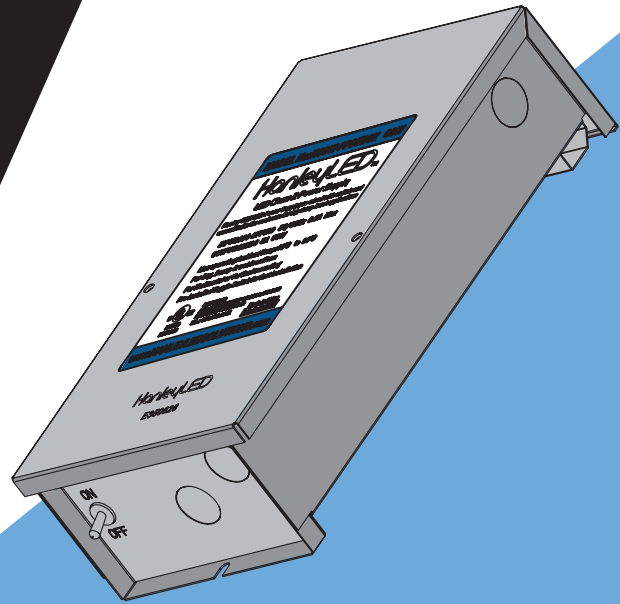

**Your favorite HanleyLED Premium Power Supplies,
pre-assembled, and pre-wired in our ready to
install SPEED BOX.**

H60W-PPS5BX212 (12V)

H60W-PPS5BOX12 (12v)



- **SPEED UP INSTALL TIME**
- **UL CLASSIFIED FOR DRY, DAMP, & WET LOCATIONS**
- **PRE-INSTALLED TOGGLE SWITCH**
- **FOR HORIZONTAL OR VERTICAL MOUNTING**
- **PRE-CUT HOLES WITH UL CAPS FOR UNUSED HOLES**
- **AVAILABLE SPEED BOX OPTIONS:**

- **H60W-PPS5BX212 (2X 12V)**
- **H60W-PPS5BOX12 (12v)**
- **H150W-PPS5BOX12 (12v)**
- **H150W-PPS5BOX24 (24v)**



H150W-PPS5BOX12 (12v)

H150W-PPS5BOX24 (24v)



*Power Supply

*All Speed Boxes come with a Premium 7 year HanleyLED Power Supply.

*Empty Speed Boxes are not available at this time.

SPEED BOX

H60W-PPS5BX212



Features

- Fitted with 2 H60W-PPS5 Power Supply ([download spec sheet here](#))
- Great versatility with Vertical or Horizontal mounting
- Pre-installed UL Recognized Toggle Switch for even faster install
- Plastic UL knockout caps and mounting screws included
- UL Listed E350828
- Easy to remove Galvanized Cover for faster service calls
- Dry, Damp or Wet Location rated

Mounting & Wiring

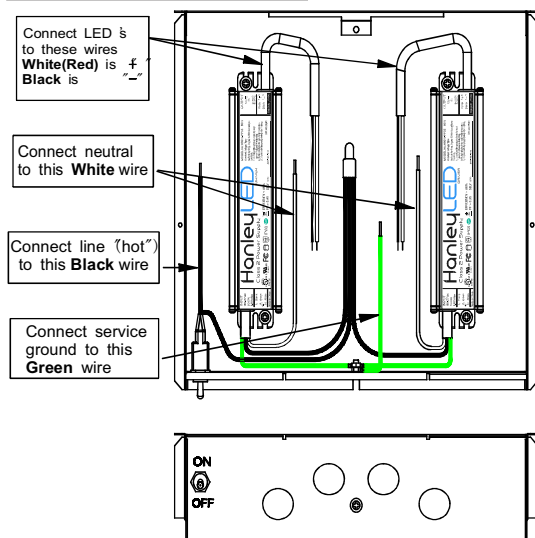
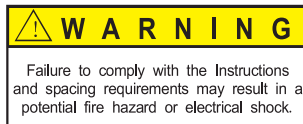

Specifications

Type	Power Supply Enclosure
Input Voltage	12vDC
Watts	2 x 60w
Size	308.4x292x75.2 mm 12x11.5x3 in (LxWxH)
Weight	2.5KG 5.5 LBS
Packaging	Individually Boxed 5 Units Per Case
Safety Rating	Class 2 for use with LEDs and LED signage

Profile Drawings

Junction Box Material: Galvanized plate,
Thickness: 0.7mm (0.027")

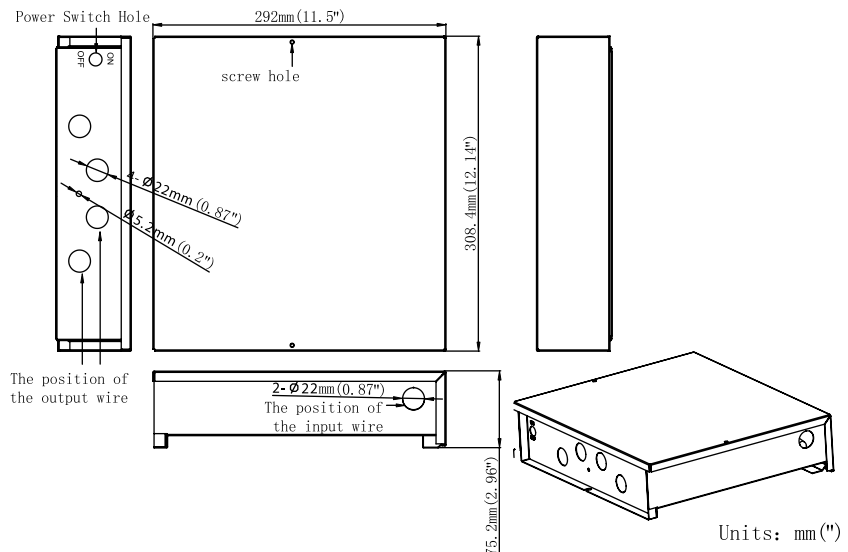

Units: mm (")

- Install the Speed Box in an accessible location and securely fasten in place.
 - The Speed Box can be installed either horizontally or vertically (see picture for acceptable orientation). Do NOT place it in a location subject to standing water.
 - Do not mount to a ceiling grid.
- The Speed Box includes drain holes for water egress so that no drilling is required.
- When mounting in a wet/damp/dry location, please use weatherproof conduit and connectors for the primary power entry and exit points of the Speed Box.
- Do not mount any additional LED Power Supplies into the Speed Box to avoid overheating.
- Input range: 100-277 volts only. Make sure the primary wiring is routed such that it does not compromise the spacing requirements. Orient wire connections off bottom of box.
- Wiring:
 - Ensure that service power is turned off before making any wiring connections.
 - Connect free white wire to service neutral.
 - Connect free black wire from switch to the service line ("hot") wire.
 - Connect the service ground to the pre-bounded green wire in the enclosure. (please refer to drawings).
 - After each wire enters the enclosure, it should be formed into a drip loop to allow moisture to naturally flow to the bottom of the loop, keeping water from ingressing into wires and connections.
- Use provided plastic caps to plug any unused holes when wiring is complete.
- Secure the cover with metal screws provide. Do NOT leave the cover off of the box.

SPEED BOX

H60W-PPS5BOX12



Features

- Fitted with 1 H60W-PPS5 Power Supply ([download spec sheet here](#))
- Great versatility with Vertical or Horizontal mounting
- Pre-installed UL Recognized Toggle Switch for even faster install
- Plastic UL knockout caps and mounting screws included
- UL Listed E350828
- Easy to remove Galvanized Cover for faster service calls
- Dry, Damp or Wet Location rated

Mounting & Wiring

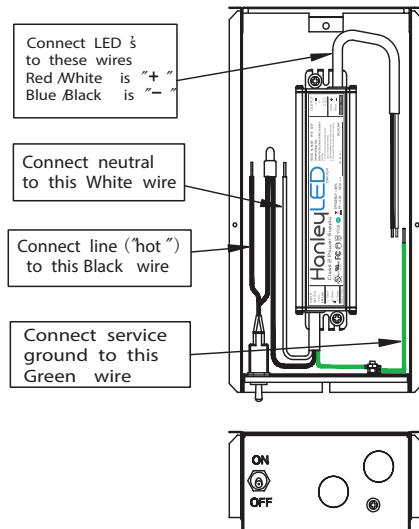
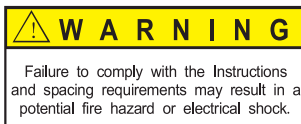

Specifications

Type	Power Supply Enclosure
Input Voltage	12vDC
Watts	60w
Size	271.5x145x73.2 mm (LxWxH)
Weight	1.2KG
Packaging	Individually Boxed 10 Units Per Case
Safety Rating	Class 2 for use with LEDs and LED signage

Profile Drawings

Junction Box Material:Galvanized

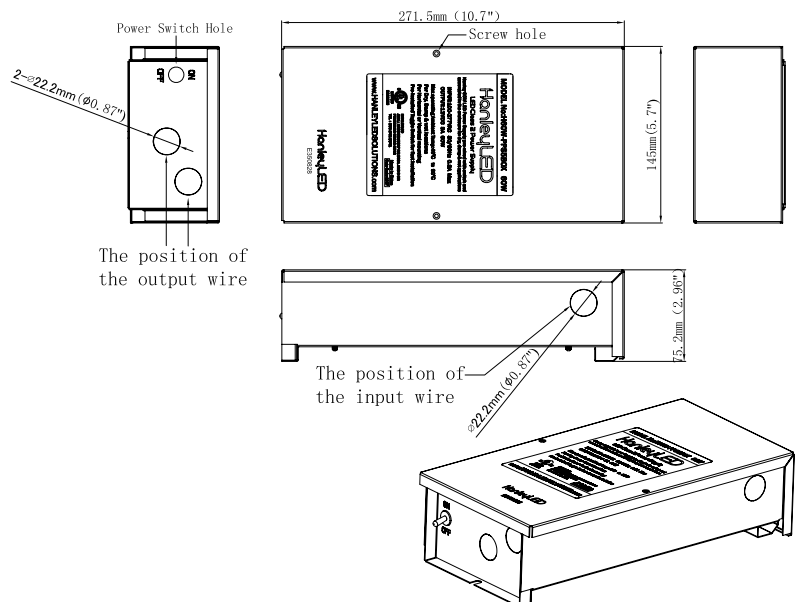

- Install the Speed Box in an accessible location and securely fasten in place.
 - a) The Speed Box can be installed either horizontally or vertically (see picture for acceptable orientation). Do NOT place it in a location subject to standing water.
 - b) Do not mount to a ceiling grid.
- The Speed Box includes drain holes for water egress so that no drilling is required.
- When mounting in a wet/damp/dry location, please use weatherproof conduit and connectors for the primary power entry and exit points of the Speed Box.
- Do not mount any additional LED Power Supplies into the Speed Box to avoid overheating.
- Input range: 100-277 volts only. Make sure the primary wiring is routed such that it does not compromise the spacing requirements. Orient wire connections off bottom of box.
- Wiring:
 - a) Ensure that service power is turned off before making any wiring connections.
 - b) Connect free white wire to service neutral.
 - c) Connect free black wire from switch to the service line ("hot") wire.
 - d) Connect the service ground to the pre-bounded green wire in the enclosure. (please refer to drawings).
 - e) After each wire enters the enclosure, it should be formed into a drip loop to allow moisture to naturally flow to the bottom of the loop, keeping water from ingressing into wires and connections.
- Use provided plastic caps to plug any unused holes when wiring is complete.
- Secure the cover with metal screws provide. Do NOT leave the cover off of the box.

SPEED BOX

H150W-PPS5BOX12



Features

- Fitted with 1 H150W-PPS5 Power Supply ([download spec sheet here](#))
- Great versatility with Vertical or Horizontal mounting
- Pre-installed UL Recognized Toggle Switch for even faster install
- Plastic UL knockout caps and mounting screws included
- UL Listed E350828
- Easy to remove Galvanized Cover for faster service calls
- Dry, Damp or Wet Location rated

Mounting & Wiring

WARNING

Failure to comply with the Instructions and spacing requirements may result in a potential fire hazard or electrical shock.

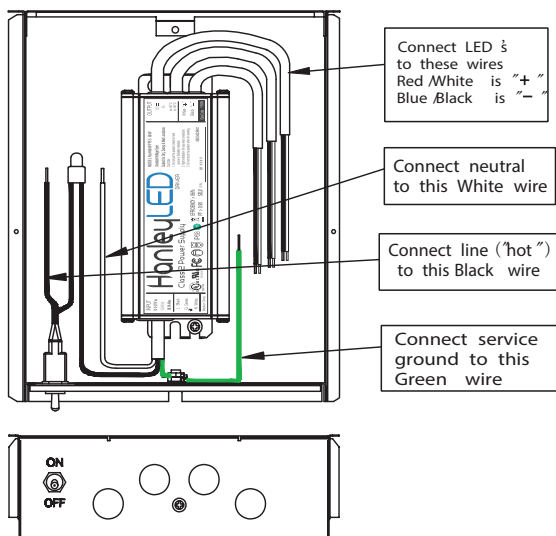

Specifications

Type	Power Supply Enclosure
Input Voltage	12vDC
Watts	150w
Size	308.4x292x75..2mm (LxWxH)
Weight	2.5KG
Packaging	Individually Boxed 5 Units Per Case
Safety Rating	Class 2 for use with LEDs and LED signage

Profile Drawings

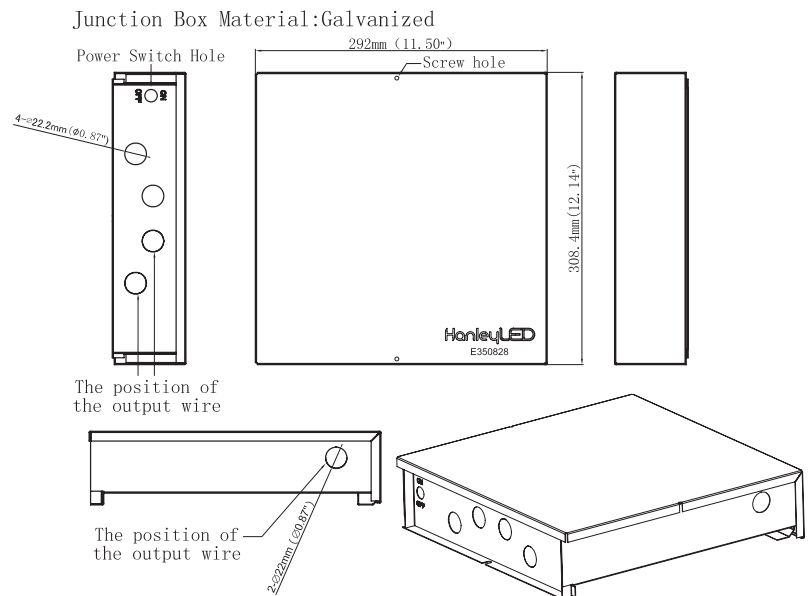

- Install the Speed Box in an accessible location and securely fasten in place.
 - a) The Speed Box can be installed either horizontally or vertically (see picture for acceptable orientation). Do NOT place it in a location subject to standing water.
 - b) Do not mount to a ceiling grid.
- The Speed Box includes drain holes for water egress so that no drilling is required.
- When mounting in a wet/damp/dry location, please use weatherproof conduit and connectors for the primary power entry and exit points of the Speed Box.
- Do not mount any additional LED Power Supplies into the Speed Box to avoid overheating.
- Input range: 100-277 volts only. Make sure the primary wiring is routed such that it does not compromise the spacing requirements. Orient wire connections off bottom of box.
- Wiring:
 - a) Ensure that service power is turned off before making any wiring connections.
 - b) Connect free white wire to service neutral.
 - c) Connect free black wire from switch to the service line ("hot") wire.
 - d) Connect the service ground to the pre-bounded green wire in the enclosure. (please refer to drawings).
 - e) After each wire enters the enclosure, it should be formed into a drip loop to allow moisture to naturally flow to the bottom of the loop, keeping water from ingressing into wires and connections.
- Use provided plastic caps to plug any unused holes when wiring is complete.
- Secure the cover with metal screws provide. Do NOT leave the cover off of the box.

SPEED BOX

H150W-PPS5BOX24



Features

- Fitted with 1 H150W-PPS524V Power Supply ([download spec sheet here](#))
- Great versatility with Vertical or Horizontal mounting
- Pre-installed UL Recognized Toggle Switch for even faster install
- Plastic UL knockout caps and mounting screws included
- UL Listed E350828
- Easy to remove Galvanized Cover for faster service calls
- Dry, Damp or Wet Location rated

Mounting & Wiring

WARNING

Failure to comply with the Instructions and spacing requirements may result in a potential fire hazard or electrical shock.

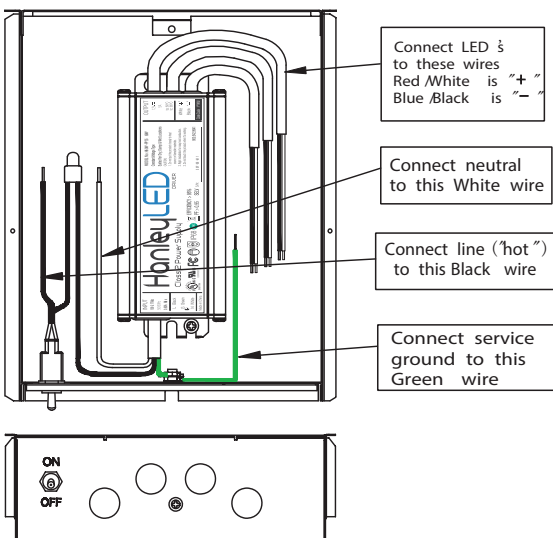

Specifications

Type	Power Supply Enclosure
Input Voltage	24vDC
Watts	150w
Size	308.4x292x75..2mm (LxWxH)
Weight	2.5KG
Packaging	Individually Boxed 5 Units Per Case
Safety Rating	Class 2 for use with LEDs and LED signage

Profile Drawings

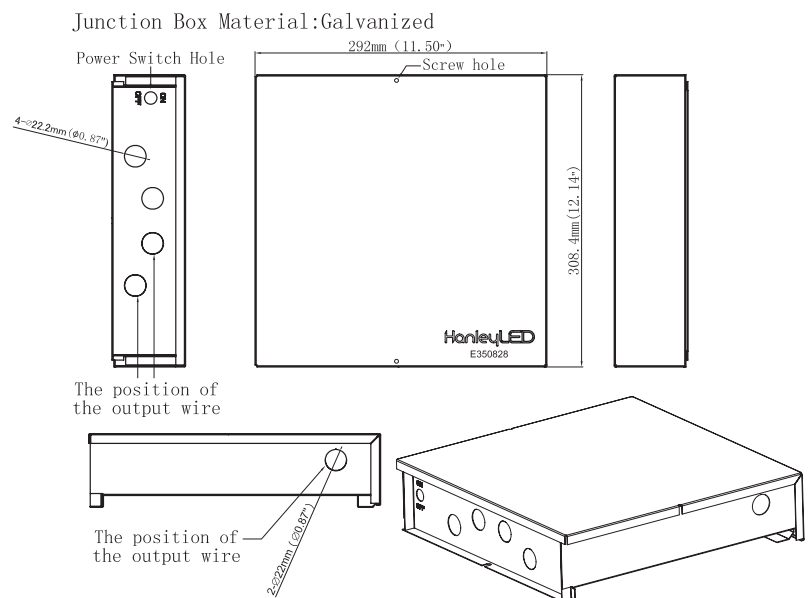

- Install the Speed Box in an accessible location and securely fasten in place.
 - a) The Speed Box can be installed either horizontally or vertically (see picture for acceptable orientation). Do NOT place it in a location subject to standing water.
 - b) Do not mount to a ceiling grid.
- The Speed Box includes drain holes for water egress so that no drilling is required.
- When mounting in a wet/damp/dry location, please use weatherproof conduit and connectors for the primary power entry and exit points of the Speed Box.
- Do not mount any additional LED Power Supplies into the Speed Box to avoid overheating.
- Input range: 100-277 volts only. Make sure the primary wiring is routed such that it does not compromise the spacing requirements. Orient wire connections off bottom of box.
- Wiring:
 - a) Ensure that service power is turned off before making any wiring connections.
 - b) Connect free white wire to service neutral.
 - c) Connect free black wire from switch to the service line ("hot") wire.
 - d) Connect the service ground to the pre-bounded green wire in the enclosure. (please refer to drawings).
 - e) After each wire enters the enclosure, it should be formed into a drip loop to allow moisture to naturally flow to the bottom of the loop, keeping water from ingressing into wires and connections.
- Use provided plastic caps to plug any unused holes when wiring is complete.
- Secure the cover with metal screws provide. Do NOT leave the cover off of the box.